



4 Ivy House Court, Scunthorpe, DN16 3GS

£135,000

Perfect first time buy in a convenient but quiet area, available to buy with no chain and vacant possession, this two bedroom home has the added conservatory for extra living space. Sat on a cul-de-sac with a private drive for two cars this is ideal for anyone wanting to get on the ladder or as a downsize. The rooms are good sizes with a hall, lounge, kitchen and conservatory on the ground floor, with two double bedrooms and a bathroom on the first. Decoration is mostly neutral and the property has been maintained well throughout. If you would like to view please get in touch.



Hall

Lounge 14'5" x 11'10" (4.41 x 3.63)



Bedroom Two 8'10" x 11'10" (2.70 x 3.63)



Bathroom 6'9" x 5'5" (2.06 x 1.67)



Kitchen 9'8" x 11'10" (2.97 x 3.63)



Conservatory 11'7" x 9'9" (3.55 x 2.98)



Outside



Landing

Bedroom One 9'8" x 11'11" (2.97 x 3.65)



Ground Floor

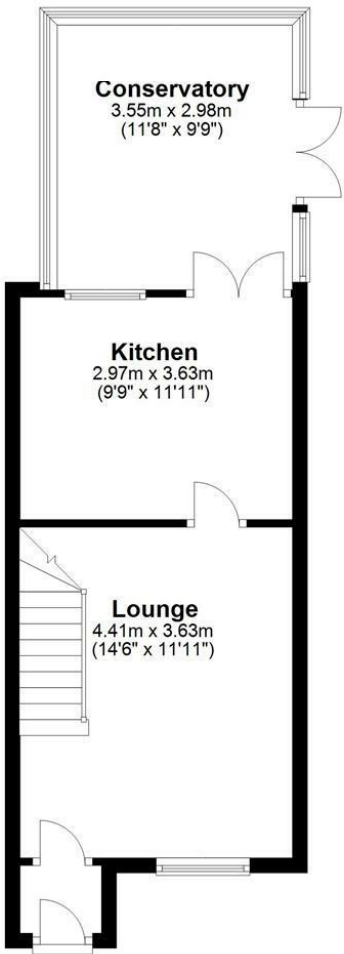

Total area: approx. 66.4 sq. metres (715.2 sq. feet)

Area Map

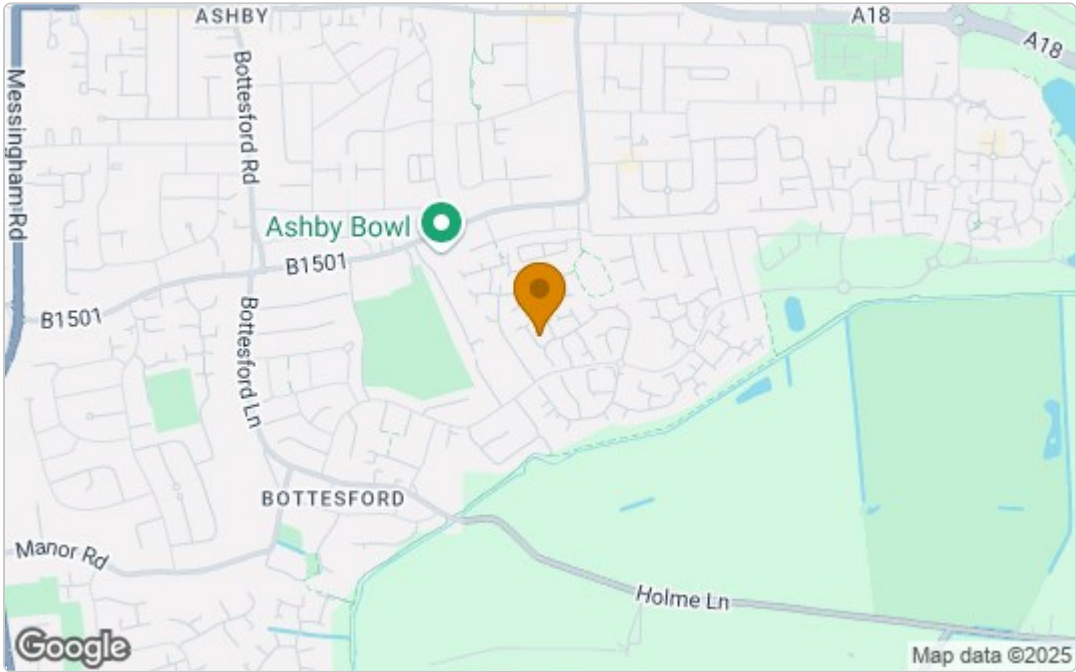

Energy Efficiency Graph

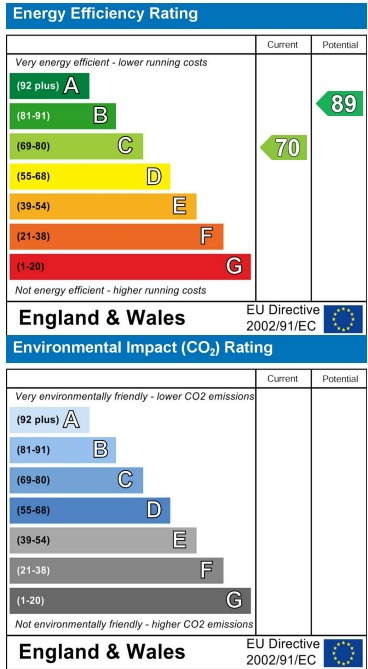

These particulars, whilst believed to be accurate are set out as a general outline only for guidance and do not constitute any part of an offer or contract. Intending purchasers should not rely on them as statements of representation of fact, but must satisfy themselves by inspection or otherwise as to their accuracy. No person in this firms employment has the authority to make or give any representation or warranty in respect of the property.